

Slindon Church of England Primary School

January 2022



Dear Parents/ Carers

Happy New Year to you all! It was lovely to see so many families back last week, after a challenging second half to the Autumn Term, with the rise in Coronavirus cases amongst our community. There is some important information on page 2 of this newsletter, with some clear actions specific to our school to help us manage any further outbreaks, particularly in light of the changes to the isolation period announced this week. If you read nothing else, please do read page 2 (though I have tried hard to make the rest of the newsletter super lovely and exciting!) As you will know, transmission rates continue to be very high and remain high in schools within the County. A link to the full updated guidance is at the bottom of page 2, for your information.

We remain in class bubbles this half term but have resumed Collective Worship in Coronation Hall each week, sitting as separate classes. We will endeavour to share aspects of our Collective Worship with you on our Facebook Page each week. After school clubs begin next week, again in class bubbles.

I am pleased to be able to share some fantastic plans of what our new library will look like on page 3. We were able to forge ahead with the 'design phase' last term and hope to get a final sign-off and for work to begin this term. We need some help with painting before work begins— see more on page 3.

There is news and celebration of all of your fundraising efforts on page 4. The money raised last term was phenomenal— we can't thank you enough for your support. This money is being put straight towards an enrichment experience for the children very soon...I shall say no more for now but you'll be hearing all about it soon!

We are thrilled to tell you about a new two-year project that the school is involved in on page 4, which will once again put Learning Outside the Classroom (LOtC) back at the core of our curriculum. We have paused our visits to the Forest just for this half term, to reduce the need for additional helpers in school, as part of our Covid Risk Assessment, but will begin them again after the half-term holiday.

There is more news and information in the remainder of the newsletter, not to mention 'cake' on page 5 and the usual 'important dates' section on page 6. Please note the upcoming Parent/ Carer Consultation Evening in the last week of half term. We look forward to seeing you there.

Lucy Cooper
(Headteacher)



Every Term throughout the pandemic, I attend a multi-agency 'Managing Coronavirus in Schools' meeting. Our meeting this week highlighted that many schools in West Sussex continue to experience Covid outbreaks and rates of transmission continue to be very high. It is also clear that as guidance changes, there is further clarity needed as schools continue to manage risk.

Whilst we are mindful of this alongside our usual busy lives, I thought it may be helpful to identify a few clear actions so that we can continue to try and minimise the risk of transmission;

- If your child has Covid symptoms, they should get a PCR test. This is different from an LFD (Lateral Flow Device), when your child/ children have symptoms, a PCR test should be used. If possible, the quickest way to get a result and to help us manage an outbreak is to visit a drive-in or walk-in testing site.
- If a member of your family (such as parents/ carers) test positive, making your children 'close contacts', it is recommended that children do an LFD for seven days, whilst attending school– if they don't have any symptoms. If they have symptoms, a PCR test should be used.
- From this week, if children test positive on an LFD, they do not need to get a PCR. Children who test positive on an LFD should not come to school and we ask that you contact us before bringing your children back to school.
- Contact tracing continues to be problematic, therefore we will continue to let you know if there is a positive confirmed case, as we did last term. As we remain in class bubbles, if a positive case is confirmed in your child's class, it is recommended that you test your child with an LFD for seven days. (Last term a number of asymptomatic children were identified as positive cases just through doing an LFD when families knew there was a positive case in the class– so we know this helps to identify cases and manage transmission).
- With the isolation period being reduced in some cases, we now ask that you communicate with us before sending your child back to school. Guidance is now that you may be able to end self-isolation before the full 10 days based on the following;
 - ⇒ *You can take an LFD test from 6 days after the day your symptoms started (or the day your test was taken if you did not have symptoms), and another LFD test on the following day. The second LFD test should be taken at least 24 hours later. If both these test results are negative, and you do not have a high temperature, you may end your self-isolation after the second negative test result.*

If individuals are ending their self-isolation early (before 10 days), official guidance advises that they avoid close contacts, which is of course difficult to do in classrooms. Therefore, I ask that you speak with myself (or Mrs Cooper or Mrs Flower in the office) before sending children back to school before the 10 days isolation has finished. This enables us to risk-assess alongside our overview of cases within school.

Finally, if you haven't done so already, please order a number of LFD tests for your household in the event that we do experience another outbreak, and your child is identified as a close contact. Do let us know if you need one and have been unable to source any and we will endeavor to help.

<https://www.gov.uk/government/publications/covid-19-stay-at-home-guidance/stay-at-home-guidance-for-households-with-possible-coronavirus-covid-19-infection>

Slindon Primary School

Proposed Library Design

Don't the plans for our new library look amazing! Before work begins we need some help to paint the walls. Please let us know if you can help us – we can't pay you but we will provide tea, cake and the radio station of your choice! Please see Miss Cooper if you can kindly help.

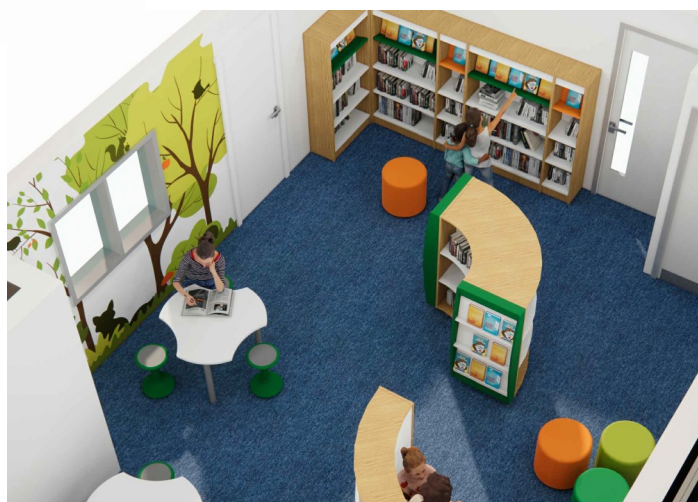

FUNDRAISING

A huge **thank you** to everyone for the efforts and generosity you showed in fundraising in the last weeks of the Autumn Term. We raised an astonishing £432.00 from the raffle, tombola and film nights. Mrs Denton raised a fantastic £370 from her Christmas stall, bringing our total to £802.00! This money will be put directly towards an enrichment experience for the children this half term which will enhance their learning and one that they will love and hopefully remember forever! We are so truly grateful to you all for such fantastic efforts!

Mrs Denton also fundraised separately for our school at events such as the Arundel Christmas Market and with the money she raised there, has purchased a 'mud kitchen' (see photo) and a number of other resources for Catkin Class.

Children in Catkin Class are thoroughly enjoying using it already, and I recommend a mud tea and mud pie from the Squirrels if the thought ever takes your fancy.



I am so pleased to tell you that after a successful National Lottery Heritage bid by 'Friends of the South Downs', we are incredibly lucky to be one of a small number of schools who will be involved in a two-year centenary project, enabling our children (and staff!) to learn more about and spend more time in the beautiful South Downs National Park. 2023 marks the centenary of the Friends of the South Downs, formerly, the South Downs Society, and previous to that, the Society of Sussex Downsmen. The successful bid and subsequent project allows our children to be involved in 'South Downs for All: Schools Heritage Project', experiencing heritage workshops, field visits and many more activities working with experts within the South Downs National Park.

I look forward to sharing more with you about this. It feels fantastic to be able to put Learning Outside the Classroom (LOtC) back at the core of our curriculum with this project, after the challenges that Covid has brought over the last couple of years.





Please be mindful of how cold it is in school– just as it was last year, with the exception that at this time last year, many of the children were learning remotely, so may not have experienced the school being quite so cold. Throughout the Coronavirus Pandemic, I have communicated that all doors and windows need to remain open and so of course, in the darkest depths of winter it is particularly cold.

Each classroom has an electronic device which measures temperature, air quality and carbon monoxide emissions. This ensures that the teachers can monitor air flow and temperature, but it is cold in school.

Please encourage your child to wear additional layers if they are feeling the cold. We have a large amount of second hand uniform in school if you would like to ask about additional clothing for your child/ children.

We would all like to say a heartfelt thankyou for the Christmas gifts that families gave at the end of last term. We are always incredibly grateful for your kindness and generosity.

Please know that whilst giving presents to staff is truly appreciated, we never want families to feel that they ought to do so, just because other families do. I worry sometimes that it has become expected, but it certainly isn't from us here at school.

Personally, my favourite thing to receive is a card with words of kindness and appreciation.

These are kept by teachers forever (and make our eyes red and watery!)



Valentine's Day Cake Sale

Monday 14th February 2022– End of the day



- Please bring cake donations to school (remember no nut products)*
- Please bring money to buy cakes*



Important Dates to Remember for the Spring Term 1

Remember you can keep an eye on the calendar on our school website by just googling it from your mobile phone— you don't need to log in to do this. Texts are sometimes sent out as a helpful reminder.

- **Saturday 15th January 2022– Deadline for applications for Reception 2022–** <https://www.westsussex.gov.uk/education-children-and-families/schools-and-colleges/school-places/apply/starting-school-places>
- **Monday 17th January 2022–** After School Clubs begin
- **Monday 14th February 2022–** PFA Fundraiser– Valentine's Day Cake Sale
- **15th-17th February 2022– Parent/ Carer Consultation Evenings–** See separate letter nearer the time.
- **Friday 18th February 2022–** Last Day of Term
- **Monday 21st– Friday 25th February 2022–** Half Term Holidays
- **Monday 28th February 2022–** First day back to school

Remaining Inset Days:

- **Tuesday 3rd May 2022 & Monday 6th June 2022**

Not sure what's going on at school?

Keep an eye on our school website, including the school calendar where you can find all the information you need.

www.slindonprimary.co.uk



SLINDON
CHURCH OF
ENGLAND
PRIMARY
SCHOOL



Meadsway
Slindon
Arundel
West Sussex
BN18 0QU
Phone: 01243 814330
Fax: 01243 814556
E-mail: office@slindonprimary.co.uk
Website: www.slindonprimary.co.uk
Headteacher: Miss Lucy Cooper

Slindon Church of England Primary School Facebook Page



We enjoy sharing what's going on in school with our families and for potential families who are looking at our school. The page won't be used to answer questions or communicate events so please continue to look at the newsletters, our calendar on the school website or call the school office if you have any queries.

ivy_the_school_dog



75
Posts

161
Followers

110
Following

Ivy the school dog 🐾
1 year old
School dog in West Sussex
Proud sock thief 🧦
#ivytheschooldog
www.slindonprimary.co.uk/





**west
sussex
music**

**Learn an
instrument in
this school**



**JOIN IN AND LET MUSIC
CHANGE YOUR LIFE**

01403 286330
westsussexmusic.co.uk/apply

Supported using public funding by



**ARTS COUNCIL
ENGLAND**

Guitar, ukulele and bass lessons.

Free taster sessions available.

Limited spaces.

1:1 or groups.

Please contact

joshua.callaghan@westsussexmusic.co.uk
or your school office.

STAGE & DANCE ACADEMY

Ginger's
Academy



DANCE READY

WEDNESDAY 3.45PM-4.45PM

STAGE READY

WEDNESDAY 4.45PM-5.45PM

GET IN TOUCH TO BOOK
YOUR PLACE

Nurture - Discovering every child's way of learning, encouraging them to stand tall, be brave & embrace their unique self.

Inspire - Offering experienced and professional tuition, providing effective training methods & exciting content.

Grow - Developing children's skills within singing, acting and dancing whilst growing confidence & self-belief.

Day: Wednesdays in term time

Age: 6-11 year olds

Address: The Victoria Institute, Arundel, BN18 9DG

🌐 Enroll online www.gingersdance.co.uk

☎ or call **07595 363578**

www.gingersdance.co.uk | 07595 363578 | jade@gingersdance.co.uk

📱 @gingersdance | 📸 @gingers_dance